



OWNER'S MANUAL

30 Lb. Stack Laundry Dryer

MODEL

GAS

L28DPS30G

CISSELL MANUFACTURING COMPANY

HEADQUARTERS

831 SOUTH FIRST ST.

P.O. BOX 32270

LOUISVILLE, KY 40232-2270

PHONE: (502) 587-1292

SALES FAX: (502) 585-3625

SERVICE/PARTS FAX: (502) 681-1275

THIS MANUAL MUST BE GIVEN TO THE EQUIPMENT OWNER.

IMPORTANT NOTICES—PLEASE READ

For optimum efficiency and safety, we recommend that you read the Manual before operating the equipment. Store this manual in a file or binder and keep for future reference.



WARNING: For your safety, the information in this manual must be followed to minimize the risk of fire or explosion or to prevent property damage, personal injury, or loss of life.

- Do not store or use gasoline or other flammable liquids or vapors in the vicinity of this or any other appliance.
- WHAT TO DO IF YOU SMELL GAS
 - Do not try to light any appliances.
 - Do not touch any electrical switch; do not use any phone in your building.
 - Clear the room, building, or area of all occupants.
 - Immediately call your gas supplier from a neighbor's phone. Follow the gas supplier's instructions.
 - If you cannot reach the gas supplier, call the fire department.

Installation and service must be performed by a qualified installer, service agency or the gas supplier.



WARNING: In the event the user smells gas odor, instructions on what to do must be posted in a prominent location. This information can be obtained from the local gas supplier.



WARNING: Wear Safety Shoes to prevent injuries.



WARNING: Purchaser must post the following notice in a prominent location:



FOR YOUR SAFETY

Do not store or use gasoline or other flammable vapors and liquids in the vicinity of this or any other appliance.



WARNING: A clothes dryer produces combustible lint and should be exhausted outside the building. The dryer and the area around the dryer should be kept free of lint.



WARNING: Be safe, before servicing machine, the main power should be shut off.



WARNING: To avoid fire hazard, do not dry articles containing foam rubber or similar texture materials. Do not put into this dryer flammable items such as baby bed mattresses, throw rugs, undergarments (brassieres, etc.) and other items which use rubber as padding or backing. Rubber easily oxidizes causing excessive heat and possible fire. These items should be air dried.



WARNING: Synthetic solvent fumes from drycleaning machines create acids when drawn through the dryer. These fumes cause rusting of painted parts, pitting of bright or plated parts, and completely removes the zinc from galvanized parts, such as the tumbler basket. If drycleaning machines are in the same area as the tumbler, the tumbler's make-up air must come from a source free of solvent fumes.



WARNING: Do not operate without guards in place.



WARNING: Check the lint trap often and clean as needed but at least a minimum of once per day.



WARNING: Alterations to equipment may not be carried out without consulting with the factory and only by a qualified engineer or technician. Only **Cissell** parts may be used.



WARNING: Remove clothes from dryer as soon as it stops. This keeps wrinkles from setting in and reduces the possibility of spontaneous combustion.



WARNING: Be Safe - shut main electrical power and gas supply off externally before attempting service.



WARNING: Never use drycleaning solvents, gasoline, kerosene, or other flammable liquids in the dryer. ***FIRE AND EXPLOSION WILL OCCUR. NEVER PUT FABRICS TREATED WITH THESE LIQUIDS INTO THE DRYER. NEVER USE THESE LIQUIDS NEAR THE DRYER..***



WARNING: Never let children play near or operate the dryer. Serious injury could occur if a child should crawl inside and the dryer is turned on.



WARNING: Never tumble fiberglass materials in the dryer unless the labels say they are machine dryable. Glass fibers break and can remain in the dryer. These fibers cause skin irritation if they become mixed with other fabrics.



WARNING: Before operating gas ignition system - purge air from Natural Gas or Propane Gas Lines per manufacturer's instructions..

CISSELL DRYER WARRANTY

The Cissell Manufacturing Company (Cissell) warrants all new equipment (and the original parts thereof) to be free from defects in material or workmanship for a period of two (2) years from the date of sale thereof to an original purchaser for use, except as hereinafter provided. With respect to non-durable parts normally requiring replacement in less than two (2) years due to normal wear and tear, and with respect to all new repair or replacement parts for Cissell equipment for which the two (2) year warranty period has expired, or for all new repair or replacement parts for equipment other than Cissell equipment, the warranty period is limited to ninety (90) days from date of sale. The warranty period on each new replacement part furnished by Cissell in fulfillment of the warranty on new equipment or parts shall be for the unexpired portion of the original warranty period on the part replaced.

With respect to electric motors, coin meters and other accessories furnished with the new equipment, but not manufactured by Cissell, the warranty is limited to that provided by the respective manufacturer.

Cissell's total liability arising out of the manufacture and sale of new equipment and parts, whether under the warranty or caused by Cissell's negligence or otherwise, shall be limited to Cissell repairing or replacing, at its option, any defective equipment or part returned f.o.b. Cissell's factory, transportation prepaid, within the applicable warranty period and found by Cissell to have been defective, and in no event shall Cissell be liable for damages of any kind, whether for any injury to persons or property or for any special or consequential damages. The liability of Cissell does not include furnishing (or paying for) any labor such as that required to service, remove or install; to diagnose troubles; to adjust, remove or replace defective equipment or a part; nor does it include any responsibility for transportation expense which is involved therein.

The warranty of Cissell is contingent upon installation and use of its equipment under normal operating conditions. The warranty is void on equipment or parts; that have been subjected to misuse, accident, or negligent damage; operated under loads, pressures, speeds, electrical connections, plumbing, or conditions other than those specified by Cissell; operated or repaired with other than genuine Cissell replacement parts; damaged by fire, flood, vandalism, or such other causes beyond the control of Cissell; altered or repaired in any way that effects the reliability or detracts from its performance, or; which have had the identification plate, or serial number, altered, defaced, or removed.

No defective equipment or part may be returned to Cissell for repair or replacement without prior written authorization from Cissell. Charges for unauthorized repairs will not be accepted or paid by Cissell.

CISSELL MAKES NO OTHER EXPRESS OR IMPLIED WARRANTY, STATUTORY OR OTHERWISE, CONCERNING THE EQUIPMENT OR PARTS INCLUDING, WITHOUT LIMITATION, A WARRANTY OF FITNESS FOR A PARTICULAR PURPOSE, OR A WARRANTY OF MERCHANTABILITY. THE WARRANTIES GIVEN ABOVE ARE EXPRESSLY IN LIEU OF ALL OTHER WARRANTIES, EXPRESS OR IMPLIED. CISSELL NEITHER ASSUMES, NOR AUTHORIZES ANY PERSON TO ASSUME FOR IT, ANY OTHER WARRANTY OR LIABILITY IN CONNECTION WITH THE MANUFACTURE, USE OR SALE OF ITS EQUIPMENT OR PARTS.

For warranty service, contact the Distributor from whom the Cissell equipment or part was purchased. If the Distributor cannot be reached, contact Cissell.

IDENTIFICATION NAMEPLATE

The Identification Nameplate is located on the rear wall of the dryer. It contains the dryer serial number, product number, model number, electrical specifications and other important data that may be needed when servicing and ordering parts, wiring diagrams, etc. Do not remove this nameplate.









TABLE OF CONTENTS

30 LB. STACK LAUNDRY DRYER

PAGE	PAGE
Model Numbers & Company Address	1
Important Notices	2-3
Dryer Warranty	4
Table of Contents	5
Warnings, Cautionary Notes and Symbols	6-7
Unpacking and General Insulation	8-9
Dryer Outline Dimension (Illustration)	10-11
Specifications	12-15
Motor List	16
Electrical Connections	17
Gas Piping Installation	18
Gas Service Installation	19
Gas Piping Installation Instructions	20
Gas Pipe Size Chart	21
Steam Piping Installation	22-23
Dryer Installation with Multiple Exhaust	24-25
Dryer Exhausts	26
Dryer Installation with Separate Exhaust	27-28
Exhaust and Venting	29-30
Rules for Safe Operation of Dryer	31
Energy Saving Tips	32-33
Operating Instructions	34-36
Two Timer Model Operation Instructions	37-38
Service Savers	39
Troubleshooting	40-43
Spark Ignition System	44-45
General Maintenance	46-47
Burner Air Inlet Shutters Adjustment	48-49
Replacing Bearings and Collars Instructions	50
Eccentric Locking Bearing Collars Removal Instructions	51
Basket Alignment	52-53
Shimming the Basket and Spider Assembly	54
Air Switch Adjustment	55
Gear Reducer Information	56
Duct Work and Air Switch Assembly	57
Dryers with Reversing Control Timer	58-59
Dryer - Front Exploded View	60-61
Single Motor Model - Rear View	62-63
Double Motor Model - Rear View	64-65
Front Panel and Door Assembly	66
Bearings and Related Parts	67
Small Gear Reducer	68
Control Panel and Access Door - Single Timer	69
Control Panel and Access Door - Two Timer	70
Control Panel and Access Door - Coin Timer	71
Thermostat Assembly	72
Standard Gas Bonnet	73
Energy-Saver Gas Bonnet	74
Steam Heating Unit - Nine Section	75
Electric Heating Unit	76
Electric Bonnet "UR" Model	77
Electric Heating Circuit	78
Reversing Control Box Assembly	79
Table for Ordering Overload Heaters for Overload Relays	80





SYMBOLS

The following symbols are used in this manual and/or on the machine. The numbers between () refer to the numbers on the machine surveys.

Symbol	Description	Part/Measurement
	NOTE!	
	Hot! Do Not Touch Heiß! Nicht Berühren Haute temperature! Ne pas toucher Caliente! no tocar Heet! Niet Aanraken	
	dangerous voltage tension dangereuse Gefährliche elektrische Spannung tension peligrosa	
	on marche Ein conectado	
	off arrêt Aus desconectado	
	start demarrage Start arranque de un movimiento	
	emission of heat in general émission de chaleur en general Warmeabgabe allgemein emisión de calor	
	cooling refroidissement Kühlen enfriamiento	

SYMBOLS

The following symbols are used in this manual and/or on the machine. The numbers between () refer to the numbers on the machine surveys.

Symbol	Description	Part/Measurement
	rotation in two directions rotation dans les deux sens Drehbewegung in zwei Richtungen movimiento rotativo en los dos sentidos	
	direction of rotation sens de mouvement continu de rotation Drehbewegung in Pfeilrichtung movimiento giratorio o rotatorio en el sentido de la flecha	
	End of Cycle	
	caution attention Achtung atencion; precaucion	

STACK DRYER SPECIFICATIONS

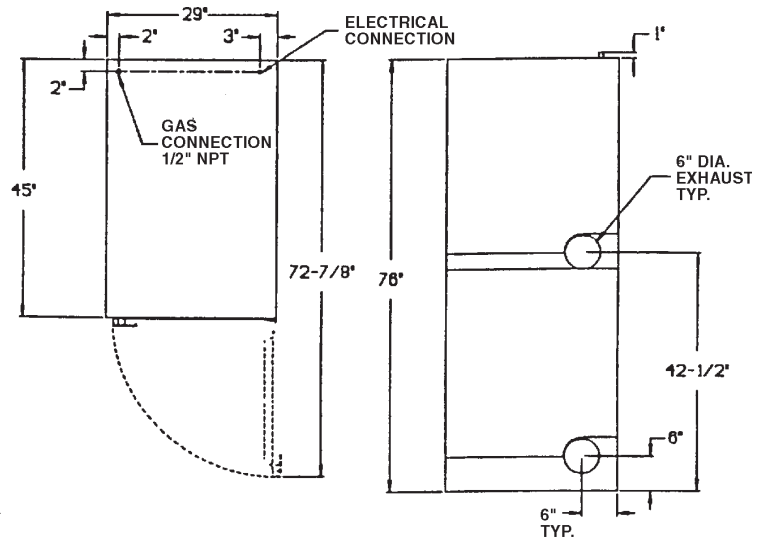

SPECIFICATIONS

Tumbler Capacity (Dry Weight)	30 lbs.
Tumbler Diameter	27"
Tumbler Depth	29"
Approx. Weight (Uncrated)	800 Lbs.
Approx. Weight (Shipping Weight)	850 Lbs.
Motor (HP)	1/2
Air Flow (Per Pocket)	450 CFM
Heat Input (Per Pocket)	75,000 BTU/H
Exhaust Diameter	6"
Door Opening	22-5/8"
Electrical Specifications	115/208/230v 50/60Hz - 1 phase

Manufacturer reserves the right to make changes in specifications without notice or obligation.

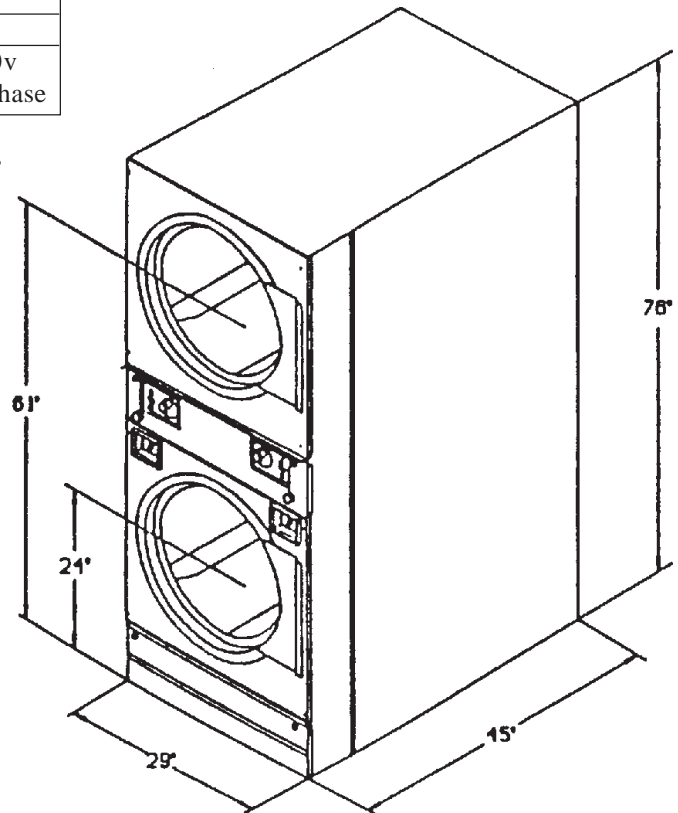

PLANNING FOR INSTALLATION

PLANNING FOR INSTALLATION

Cissell Manufacturing Co. provides quality appliances that are easy to install, operate and service. Each dryer is delivered complete and ready for connection to external vent ducts, power and gas lines. Plan for the installation of your dryer before it arrives. This will save you time and will assist your contractors at installation. Check to see if a permit is required. A preinstallation check list should include:

- ❑ A sketch of the dryer room with dimensions. Show the dryer location - place the dryers next to an outside wall if possible. Allow space for rear servicing and periodic inspection behind the dryers - (3) feet minimum is recommended for ease of servicing.
- ❑ Do not install dryer in a corrosive or contaminated atmosphere or near combustible materials. Make sure circulating air requirements are adhered to.
- ❑ Do not install or store dryer in an area where it will be exposed to water and/or weather.
- ❑ Show walls and partitions.
- ❑ Show location and size of venting duct outlet.
- ❑ Show the location of electrical power.
- ❑ Specify the location of the gas supply.
- ❑ Installation should be on a sound, carpetless and level floor capable of supporting dryer weights. Check your local building codes.
- ❑ Calculate the size of vents required to supply the dryer room with outside air (MAKE-UP AIR). Refer to the ADEQUATE AIR SUPPLY section of this manual.
- ❑ Optional: An electrical outlet box for connecting a vacuum or other tools and rear lighting for better visibility during servicing.

CODES & STANDARDS

The installation of the dryer should be performed by qualified licensed professionals in accordance with local building codes and local, state and federal standards. Warranty is void unless dryer is installed according to instructions in this manual. All dryer installations by the owner or contractors must conform to all or part of the following regulations:

United States

National Fuel Gas Code - ANSI #Z223.1 (latest edition).
National Electric Code - ANSI/NFPA #70 (latest edition).
National Electric Code - USAS-C1 (branch circuit grounding conductors to metallic boxes)

Canada

CAN 1-B149.1 & 2 - Installation codes for gas burning appliances.
CSA C22.1 Canadian Electrical Code Part 1.

PLANNING FOR INSTALLATION (CONT.)



CONSTRUCTION CLEARANCE

The installation of a dryer is not complex. The dryer requires make-up air, gas for drying heat, *electrical power*, and *air exhaust ducts*.

For safety, all installation and testing must conform to the **CODES AND STANDARDS** section of this manual.

The stack dryer may be installed in various configuration including free standing against a wall or recessed into a partition wall or room (as illustrated). It is recommended that adjacent materials be noncombustible. As illustrated, clearances to combustible construction material are minimum.

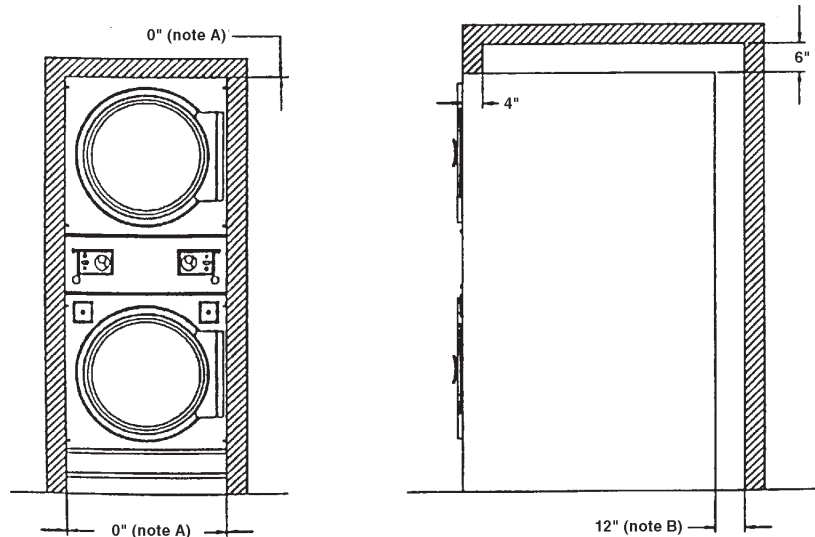

Note A

When dryer is installed flush with and protruding through a wall, the first 4" may contact combustible construction. From the point back, top clearance must be 6" and side clearance 1".

Note B

Rear clearance is 12" minimum - (36" is recommended for ease of installation, maintenance and service).

Other

2" clearance from exhaust ducting.

12" minimum clearance from top of dryer to sprinkler system.

PLANNING FOR INSTALLATION (CONT.)

ADEQUATE AIR SUPPLY

To operate safely and efficiently, a dryer must intake clean dry air, pass it through the dryer and then exhaust it outside of the building. The air taken into the dryer is called **MAKE-UP AIR**.

A dryer can quickly deplete available MAKE-UP AIR in a sealed insulated room, consequently vents to the outside of the building are required. Vents are usually openings in a wall covered with louvers.

Each L28DRS 30G dryer requires 2 square feet of unrestricted outdoor MAKE-UP AIR to operate efficiently.

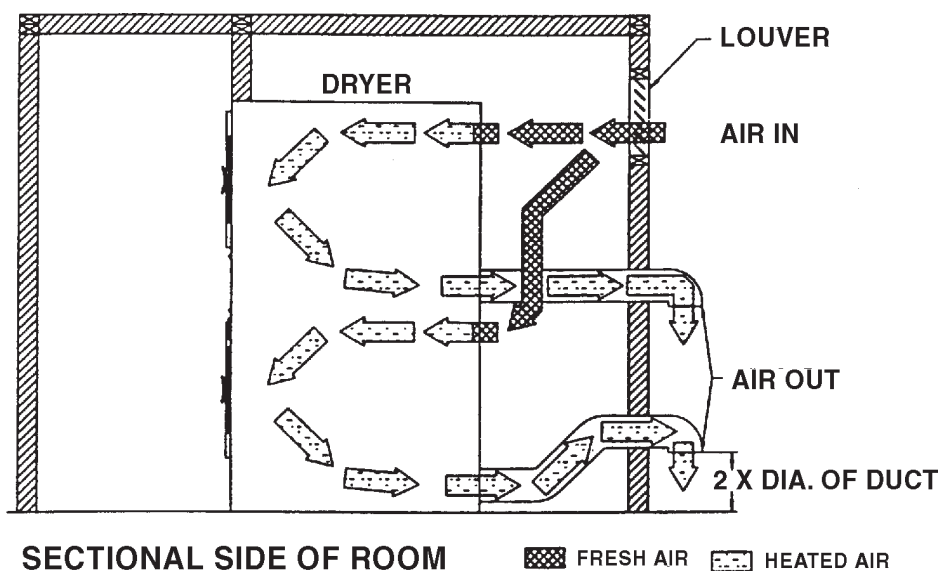

Example: For a Bank of Six Dryers,
a Total Make-up Air Opening of
1728 Square Inches is Required

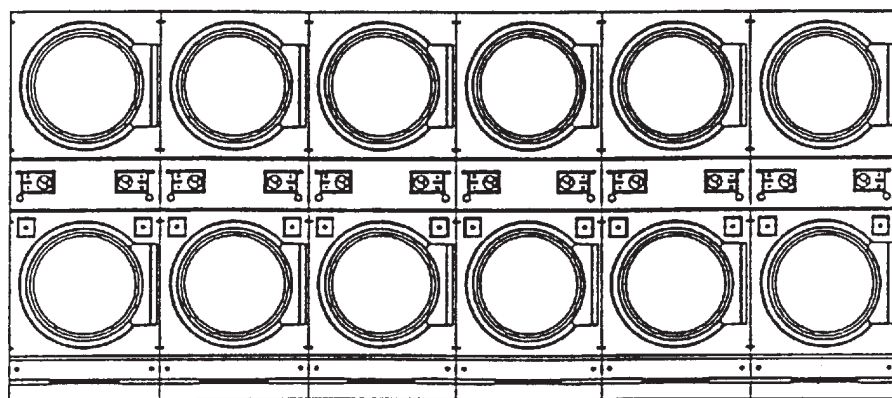

TYPICAL INSTALLATION SHOWING AIR OPENINGS

UNPACKING AND LEVELING

UNPACKING

Your new dryer should be kept in a clean environment. All major construction (i.e. walls, partitions, enclosures) should be substantially complete before unpacking. The dryer is delivered bolted to a skid and covered with a polyethylene protective cover.

- ☐ Inspect for damage before unpacking. Immediately report any apparent damage to the carrier before you sign the receipt (document the damage on the trucker's receipt).
- ☐ If damage is found after the carrier has departed, call the freight terminal immediately and request an INSPECTION AND FREIGHT CLAIM FORM. Save all packing material.
- ☐ Unpack the dryer.
- ☐ Open the upper dryer door and remove the envelope containing keys, leveling pads and INSTALLATION & OPERATION MANUAL.
- ☐ Unlock and remove the lower lint compartment door.
- ☐ Unscrew the (4) crate bolts holding dryer on the skid - save (2) crate bolts for leveling.
- ☐ Slide dryer off the skid.
- ☐ Note that external connections for electric and gas are made at the top rear of the dryer. The exhaust collars for vent ducts are located on the back for both tumblers.
- ☐ Remove shipping blocks located between tumbler and front door panel.

LEVELING

All electrical, gas and vent ducts should be in place and ready for hook-up before the dryer is moved into position.

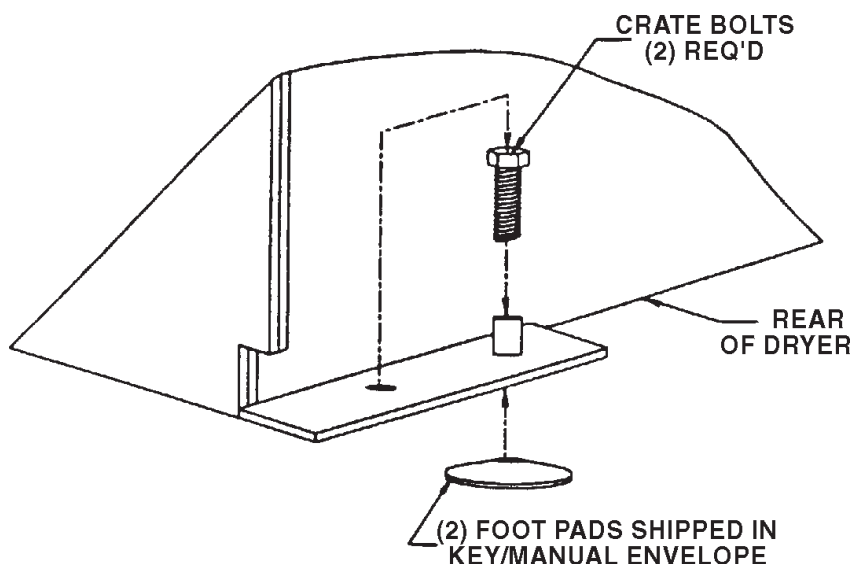

- ☐ Remove (2) foot pads from envelope (shipped in upper tumbler door).
- ☐ Screw (2) crate bolts thru rear base of dryer and into foot pads (refer to illustration). Front foot pads are factory installed.
- ☐ Level dryer from side to side.
- ☐ Tilt dryer back 2° - 3°

ELECTRICAL AND GAS INSTALLATION

ELECTRICAL

A licensed electrical contractor should install the electrical service for the dryer. Personal injury/dryer failure may result if not installed according to codes and standards.

- ❑ Remove the back guard and locate the wiring diagram on left side panel.
- ❑ Verify that the voltage, frequency and phase of the electrical service is the same as specified on the dryer data label.
- ❑ Install each dryer on a separate circuit. Check for polarity. Use copper wire - not aluminum. Provide a separate ground wire. Each circuit should include a circuit breaker of the correct amperage. Some building codes may require a ground fault interrupter (GFI) breaker.
- ❑ Connect the electrical service to the outlet box at the rear top of each dryer. Add a strain relief and grommet where the service enters the outlet box. A wiring diagram is provided with each dryer.
- ❑ Ground the dryer. The separate ground wire must be installed in accordance with best commercial practice and in compliance with local building codes and local, state and federal standards.



GAS

A licensed plumber should install the plumbing service for the dryer. Personal injury/dryer failure may result in not installed according to codes and standards.

Verify that the gas service corresponds to that specified on the dryer data label. Unless special ordered from the factory, all data is based upon dryer installation under 2,000 feet elevation.

Single dryer

- ❑ Install 1/2" nominal pipe (except butane or propane) from the service entrance to each dryer. Smaller diameter pipe will result in ignition problems, slow drying, increased use of energy and may create a safety problem.
- ❑ Install a **MAIN GAS SHUT-OFF** valve that turns off the gas supply to the dryer.
- ❑ Connect gas line to dryer gas pipe at top of dryer.

Multiple dryers

- ❑ Install a continuous loop manifold. The size and length of gas supply line, number of gas fittings, pipe line friction, gas manifold pressure and gas/air mixture can be determined by your plumber or gas company.
- ❑ Install a **MAIN GAS SHUT-OFF** valve that turns off the gas supply to the dryer.
- ❑ Connect gas line to dryer gas pipe at top of dryer.

TYPICAL GAS INSTALLATION

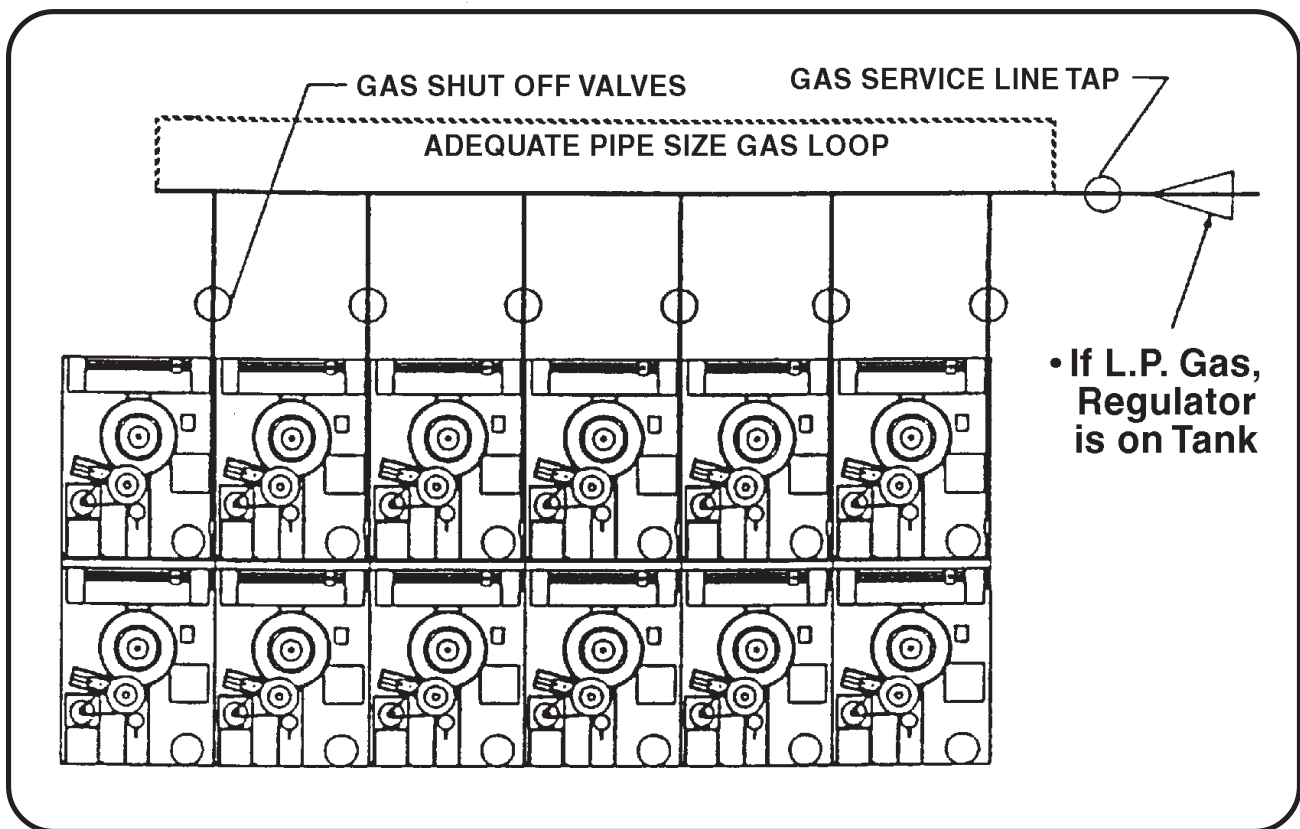

GAS DATA

TYPE OF GAS

	NATURAL	LIQUID PROPANE (L.P.)
Manifold pressure	3.5 inches W.C.	11 inches W.C.
In-line pressure (W.C.)	6.0 inches to 12.0 inches	11 inches W.C.
Orifice size (D.M.S.)	#20	3/32"

Gas outlet size 1/2" N.P.T.

BTUH input (each tumbler) 75,000

BTUH input (per dryer) 150,000

Manifold pressure measured at gas valve pressure tap when gas valve is on. Measured in inches of water column.

Drill Manufacturers Standard (D.M.S.) is equivalent to standard twist drill.

Water column (W.C.) is in inches.

Important

The dryer is set up for natural gas. If Liquid Petroleum (L.P.) Gas is to be used, a kit with instructions is shipped in the basket with the dryer.

GAS TESTING



The dryer must be isolated from the gas supply piping system by closing its individual manual shutoff valve during any pressure testing of the gas supply piping system at test pressure equal to less than 1/2 PSIG (3.5 KPA).

Failure to comply with this could cause fire or explosion and/or dryer damage.

Test each gas connection for leaks by brushing on a soapy water or detergent solution. **Never test for leaks with an open flame.**

VENTING AND EXHAUSTING

VENTING & EXHAUSTING



Design Guides



A licensed contractor should install the dryer vent ducts. Duct work not properly designed and installed or which does not meet codes and standards can be a potential source of fire, personal injury and dryer failure.

Each dryer tumbler must be exhausted outside the building via a ducting system. Basically there are (4) categories:
Individual duct - Dual duct - Main Connector duct - Custom duct

Improperly sized ducts will create excessive back pressure which results in slow drying, increase in energy usage, overheating of dryer and possible dryer damage.

Do not obstruct the flow of combustion and ventilation air.

VENT DUCTS

- ☐ Shape of duct is not critical if cross sectional area is maintained.
- ☐ Use rust resistant duct material.
- ☐ Inside of ducts should be smooth with no sheet metal screws protruding.
- ☐ Overlap all joints. YES  
- ☐ Tape all joints to avoid air loss and to avoid condensation.
- ☐ Install several clean-out and inspection doors.
- ☐ Do not exceed 20' of duct work.
- ☐ Do not use 90° turns. Use 30° or 45° instead.
- ☐ Ducts should have 2" of clearance (all around) when they go through a wall.
- ☐ Insulate ducts passing through walls or cold areas.
- ☐ Horizontal ducts exiting a building should terminate with a 90° elbow bent downward. Do not put screening or cap over end of duct. Minimum clearance from the end of 90° elbow to ground should be 2x duct diameter.
- ☐ Vertical ducts exiting through a roof should terminate with a 180° turn downward. Do not put screening or cap over end of duct. Minimum clearance from the end of 180° elbow to roof level should be 2x duct diameter.
- ☐ Do not vent into enclosed spaces - i.e. an attic. Venting must be to the outdoors.

MULTIPLE VENTED INSTALLATION

Single dryer

Whenever possible, each stack dryer tumbler should have an **individual** short straight exhaust duct.

Multiple dryers

- Whenever possible, each dryer tumbler in multiple installations should have **individual** short straight exhaust ducts.
- If an individual or dual duct is not possible, install a long tapered **main connector duct**. A duct exceeding 20' should be a custom duct designed by a professional Heating and Air Conditioner (HVAC) contractor.
- Individual tumbler ducts enter the main connector duct at a 45° angle in the direction of exhaust air flow.
- The diameter of the main connector duct progressively increases as more dryers are added. (refer to illustration).

Testing

Back pressure of ducting system should not exceed 0.3 inch water column when all dryers are operating. Use a manometer for tests. More detailed ducting information can be obtained directly from your Heating and Air Conditioning (HVAC) contractor or dealer.

Multiple vents

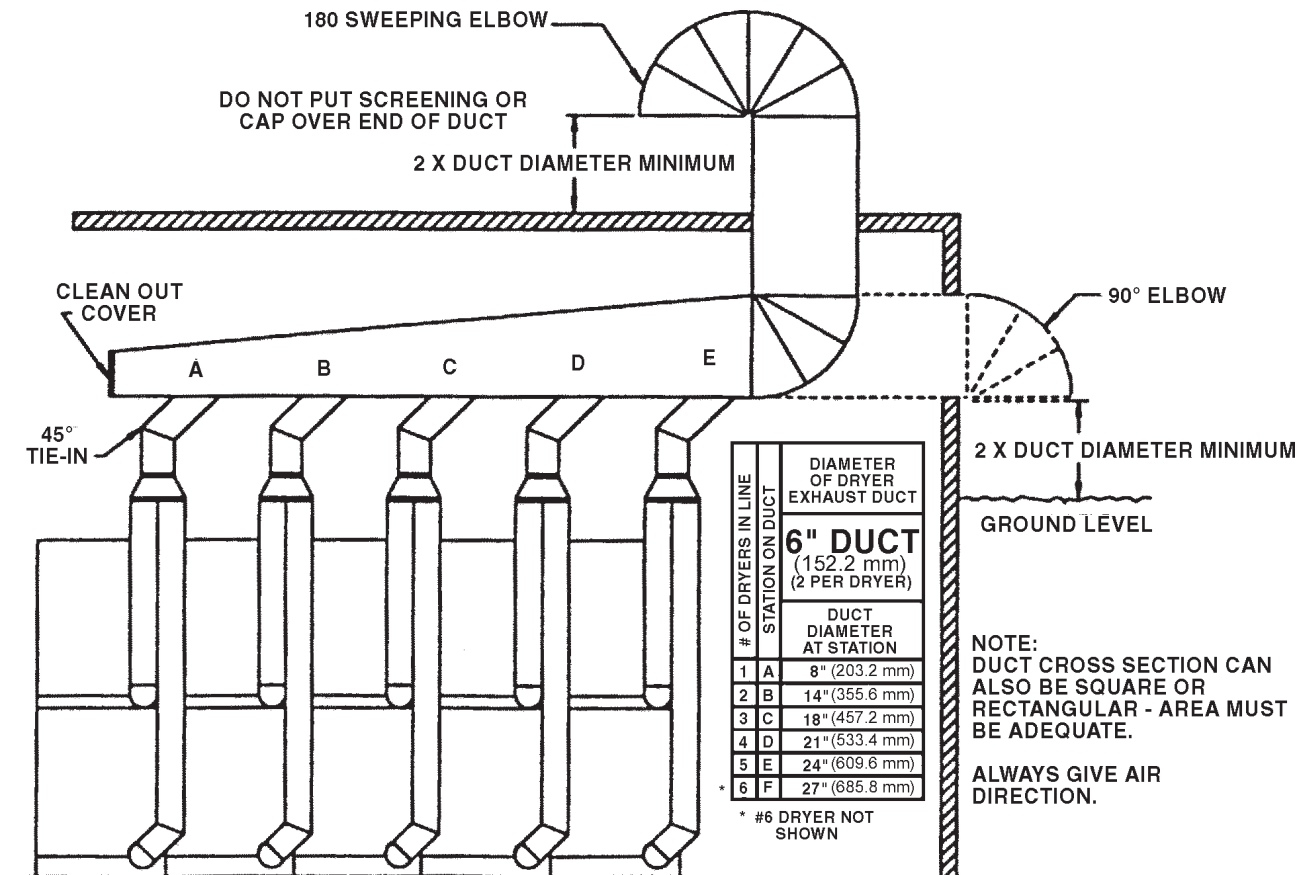

TYPICAL MULTIPLE VENTED INSTALLATION

PREOPERATIONAL TESTING

INSTALLATION CHECK

Carefully review each item in the Installation & Operation Manual.

Check the Codes & Standards section of the manual.

- ☐ Dryer installation must meet or exceed all codes and standards.
- ☐ Check the room venting. Each dryer must have sufficient MAKE-UP AIR.
- ☐ Read and follow all caution, warning and direction labels attached to the dryer.
- ☐ Check incoming electrical power - power must be identical to dryer data label.
- ☐ Check gas supply - supply must be identical to dryer data label.
- ☐ Check that all bolts, nuts, screws, terminals and fittings are secure.
- ☐ Check all safety covers and electric box covers - they must be installed.
- ☐ Check the control panel door and lint compartment doors - they should be closed and locked.
- ☐ Manually rotate the dryer tumblers and check for interference.

INITIAL OPERATION TEST

Each dryer is inspected, tested and operated at the factory before shipment. Occasionally, in transit, a dryer is subjected to excessive vibration and shock. After installation, minor adjustments may be necessary.

- ☐ Open all gas shut offs and gas valves.
- ☐ Initially load each tumbler with clean rags (removes any excess oil remaining from the manufacturing process).
- ☐ Close dryer door (on tumbler under test).
- ☐ Turn on all electric power to the dryer.

PREOPERATIONAL TESTING (CONT.)



HEAT CIRCUIT TEST

Dryers with mechanical rotary meter controls are ready for further testing.

If dryer stops or will not start, air may be in the gas supply line - refer to HEAT CIRCUIT TEST.

When a dryer is installed, the gas supply lines from the gas meter to the individual dryers are initially filled with air and not gas.

The air must be purged from the system so the direct spark ignition (DSI) can ignite.

Each time the DSI attempts ignition, air is automatically discharged (purged) from the gas lines.

- The DSI will attempt to ignite for 10 seconds. If ignition does not occur, the DSI will shut down and lock-out. A manual reset is necessary.
- If lock-out occurs, recheck that all gas shut offs and gas valves are open.
- Reset the DSI by opening and closing the tumbler door and then selecting a temperature setting.
- When the dryer is operating properly, perform a water column pressure test on each dryer tumbler. Test at the gas valve pressure tap. Refer to the Gas Data section of this manual for pressure requirements

OPERATING INSTRUCTIONS - COIN METER MODELS

ROTARY METER CONTROL PANEL

The L28DRS 30G stack dryer has (2) identical control panels. The left control panel is for the top tumbler - the right is for the bottom tumbler.

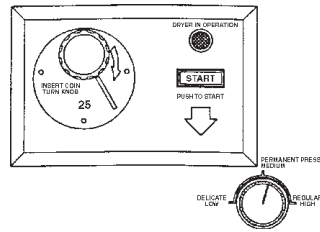

The control panel operator interface consists of a **COIN METER** slot to insert coin(s), **METER KNOB**, **TEMPERATURE SELECTOR KNOB** and **START BUTTON**.

ROTARY METER OPERATION

TO OPERATE DRYER

- ☐ Put clothes in dryer.
- ☐ Close dryer door.
- ☐ Turn Temperature Fabric Selector to desired setting. "LOW" is for delicate, sheer, and easy dry fabrics. 130° - 140°F exhaust temperature. "MEDIUM" is for synthetics and permanent press fabrics. 155°-165°F exhaust temperature. "HIGH" is for cottons, linens, and heavy fabrics. 170° -180°F exhaust temperature.
- ☐ Insert coins in **COIN METER**.
- ☐ Turn **METER KNOB** after inserting each coin - red indicator light will go on.
- ☐ Press **PUSH-TO-START** button.
- ☐ A cool-down cycle will occur the last 2 1/2 minutes of total time purchased.
- ☐ Dryer will stop when cycle is complete - red indicator light will go out.

Change temp

- ☐ While dryer is stopped or running, rotate **SELECTOR KNOB** to the new temp setting required and the controls will automatically reset to the new temp.

Stop

- ☐ Open dryer door.

Read posted safety notices and Installation & Operation manual. Review the section of the manual "Do Not Dry". If operating dryer for the first time, refer to PREOPERATIONAL TESTING section of manual.

Troubleshooting Chart

TROUBLE	CAUSE	REMEDY
"Browning" of articles.	Soap deposits.	Rewash with bleach - no soap.
Articles damaged/melted.	Plastic or rubberized articles.	Remove articles. Clean dryer.
Dryer will not run.	Tumbler door open.	Close door.
	Lint compartment door open.	Unlock & close again.
	START not activated.	Push START button.
	Incorrect amount of coins.	Insert correct amount of coins.
	Air switch faulty.	Call for service.
	No power to dryer.	Reset circuit breaker.
Noise from Tumbler.	Hard object in tumbler.	Remove object.
	Object caught in tumbler.	Unfasten object.
Control panel display off.	No power to dryer.	Reset circuit breaker.
	Control panel fault.	Call for service.
Dryer vibrates.	Tumbler scraping.	Adjust tumbler.
	Dryer not level.	Level dryer.
Dryer does not dry properly.	Lint screen blocked.	Clean lint compartment.
	Exhaust vents blocked.	Remove obstruction.
	Thermostat faulty.	Call for service.
Dryer overheating.	Lint screen blocked.	Clean lint compartment.
	Thermostat faulty.	Call for service.

MAINTENANCE



CLEANING

Failure to install, maintain and operate the dryer according to manufacturers instructions may result in conditions which can produce bodily injury and property damage.

Establish a **cleaning schedule based upon frequency of use**. The following cleaning intervals are minimum requirements. Maintain dryer efficiency by frequent removal of lint from dryer exterior and interior paying particular attention to dryer exterior and interior paying particular attention to dryer venting system. Remember lint from most fabrics is highly combustible and can create a fire hazard.

DAILY

- ❑ LINT COMPARTMENTS - remove lint.

One lint compartment door is at the bottom of dryer. Unlock, pivot door down and pull out lint drawer. Remove lint by hand.

The other lint compartment door is at center of dryer. Unlock, pivot door down and pull out lint drawer. Remove lint by hand.

Do not use a brush on the lint screen. Do not remove lint screen.

Excessive buildup of lint can affect dryer efficiency and can create a fire hazard.

Replace or close lint compartment door - do not force. Doors have safety interlocks. Dryer will not operate if doors are open.

- ❑ TUMBLER - clean tumbler interior with a nonflammable cleaner.
- ❑ EXTERIOR - clean with non-abrasive household cleaner.

MONTHLY

- ❑ LINT COMPARTMENTS - clean lint from temperature probes and bracket assemblies.

EVERY (3) MONTHS

- ❑ MOTOR AIR VENTS - remove lint from vents and surrounding area.
- ❑ DRYER FRONT PANELS - remove lint from behind the front panels and between the baskets and wrappers.
- ❑ GAS VALVE BURNER TRAIN - remove lint with a dusting brush or vacuum cleaner attachment.
- ❑ COIN SLOT - remove lint from coin slot mechanism.

Keep area clean and free from combustible material, gasoline and other flammable vapors and liquids.



MAINTENANCE (CONT.)

CLEANING (Cont.)

EVERY (6) MONTHS

- INTERNAL DUCT SYSTEM - remove lint from ducts and back draft dampers. Note that partially closed dampers can significantly reduce air flow.
- EXTERNAL VENT DUCT - remove lint.

LUBRICATION

EVERY (2) TO (3) MONTHS

- IDLER SHAFT - grease with a good grade automotive grease in the 285° range.

Motors and trunion bearings are sealed and do not require maintenance.

ADJUSTMENTS

(7) DAYS AFTER FIRST OPERATION

- Inspect and refasten all loose bolts, nuts, screws (bearing set screws), gas connections (unions, shut-off valves, orifices, etc.), electrical connections and grounding connections.

EVERY (6) MONTHS

- Replace all motor and drive belts that are cracked or frayed.
- Tighten all drive belts according to Technical Service Manual tension specifications.
- Correct any belt misalignment.
- Check the operation of all control and valves.
- Check the operation of all safety devices including door switches and lint compartment switches.

CISSELL ROTARY METER STACK

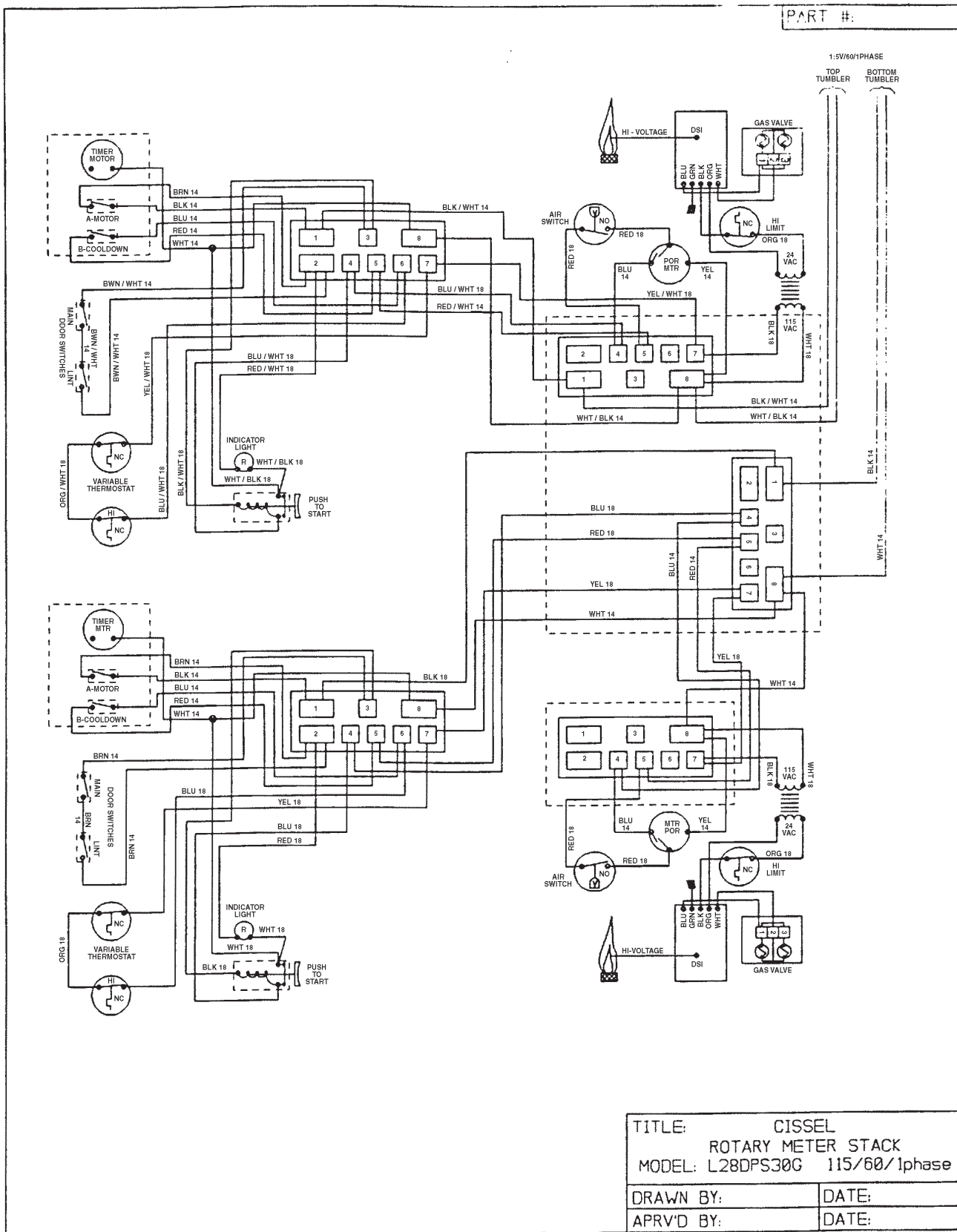

DRYER - FRONT VIEW

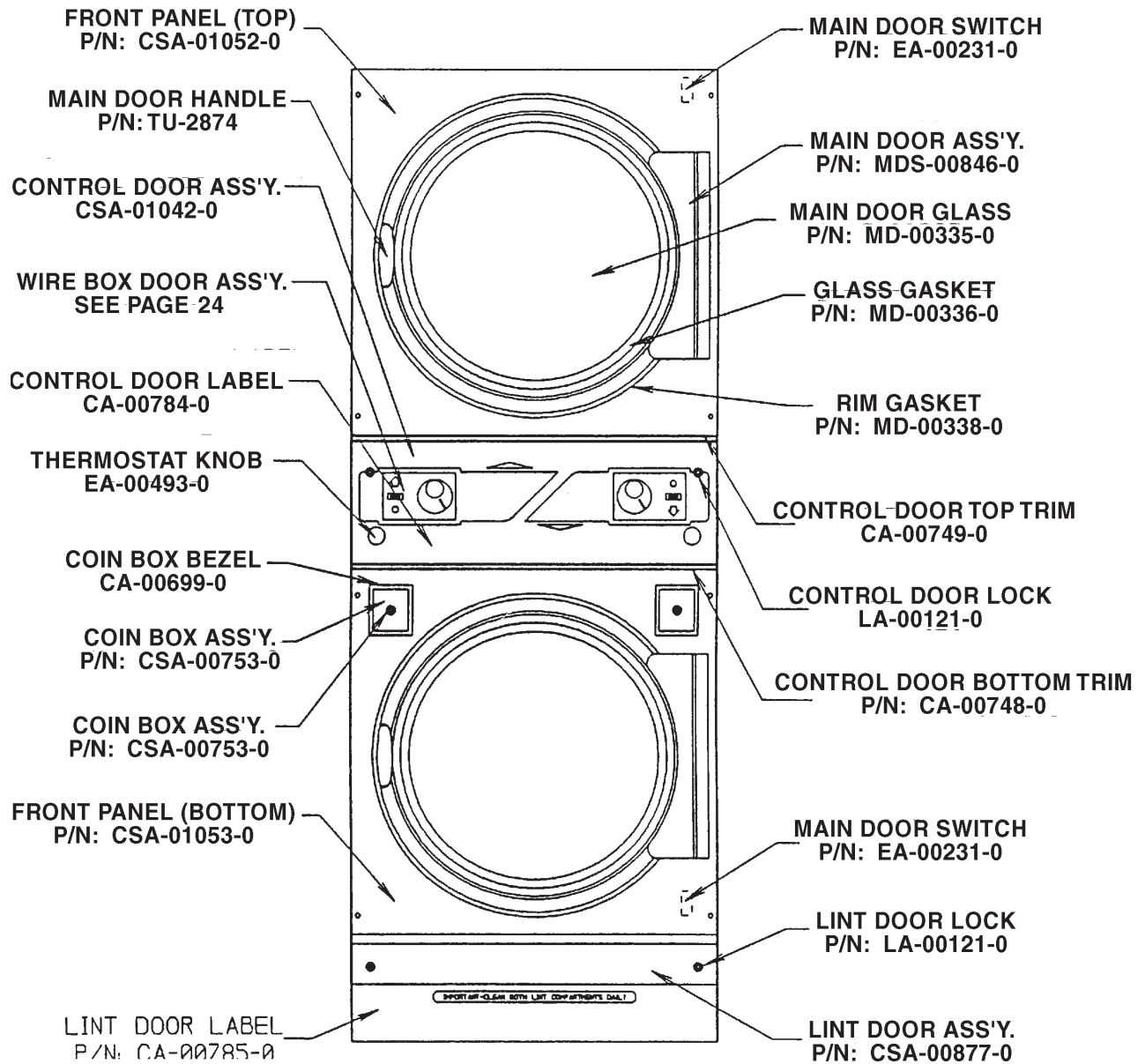

DRYER - WIRE BOX

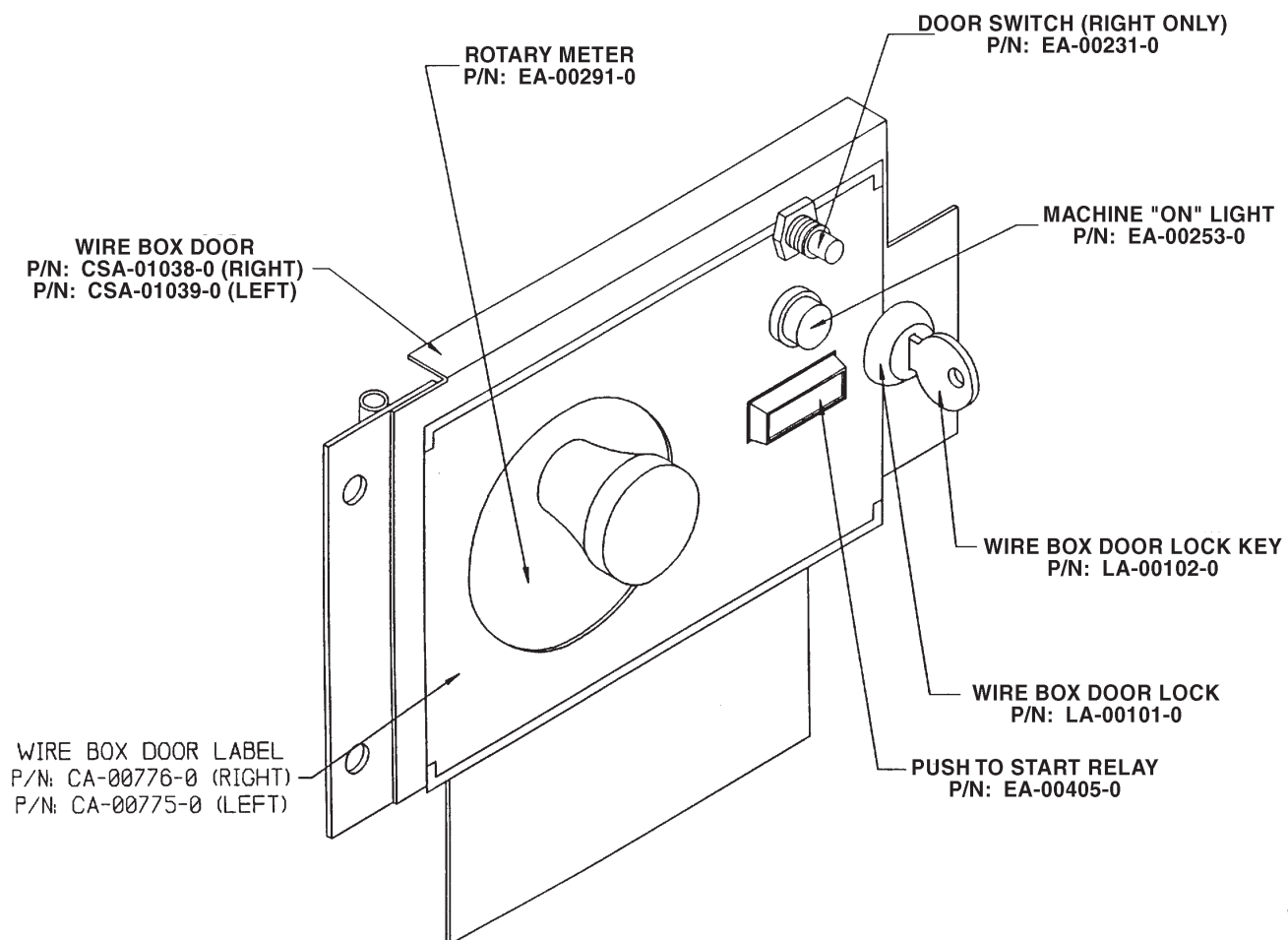

DRYER-REAR VIEW DRIVE SYSTEM

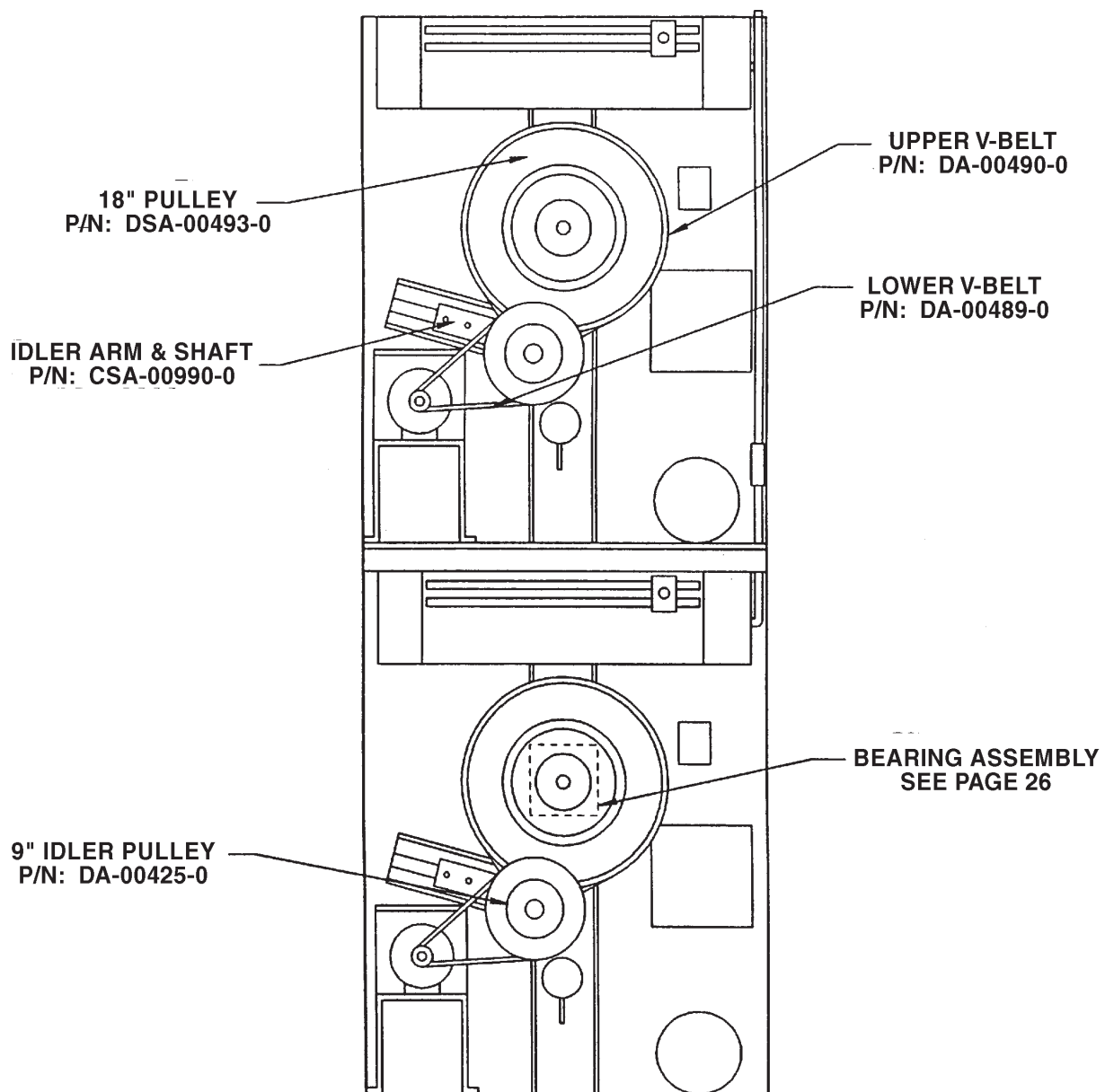

BEARING & BEARING BOX ASSEMBLY

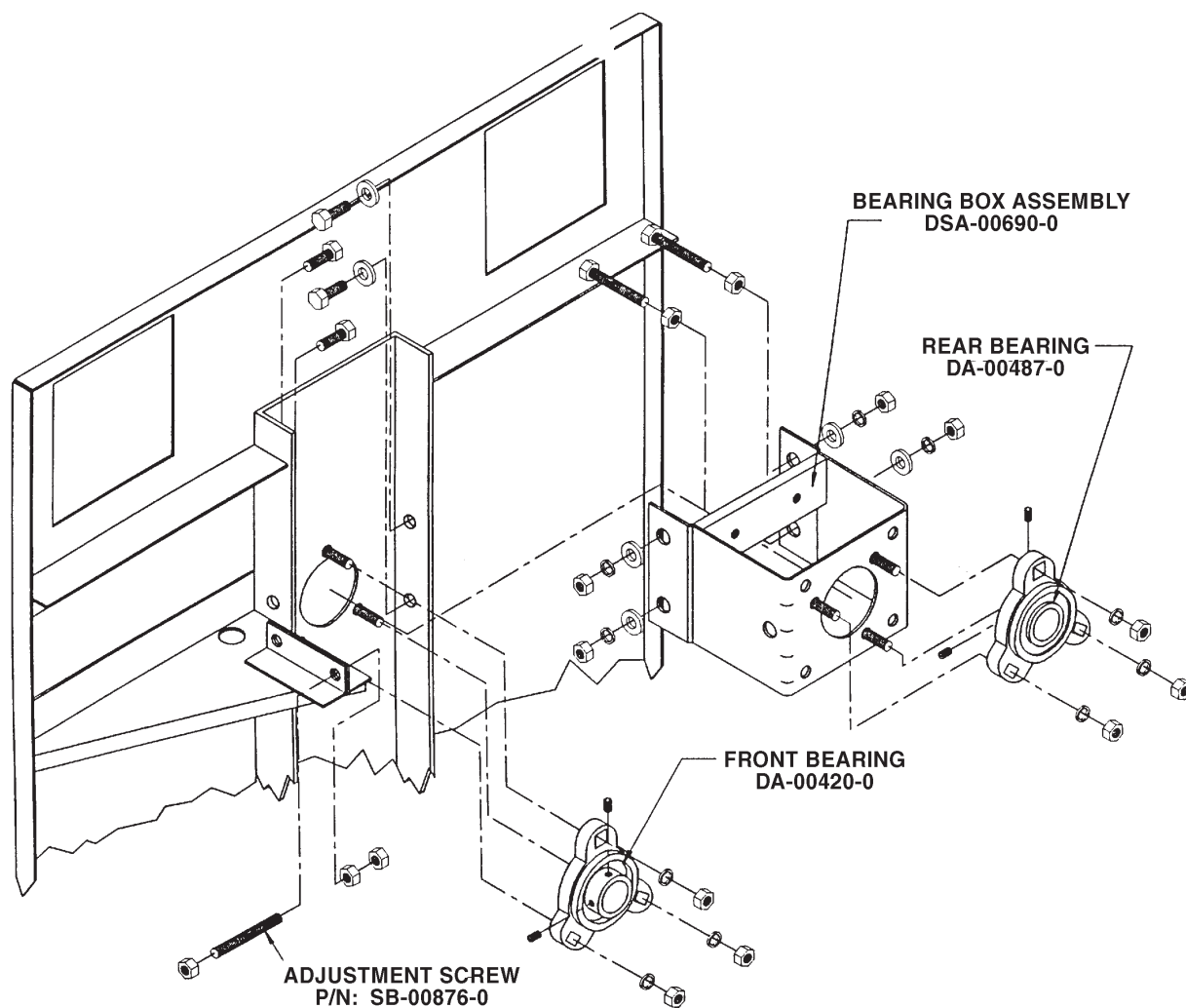

DRYER - REAR VIEW - ASSEMBLIES

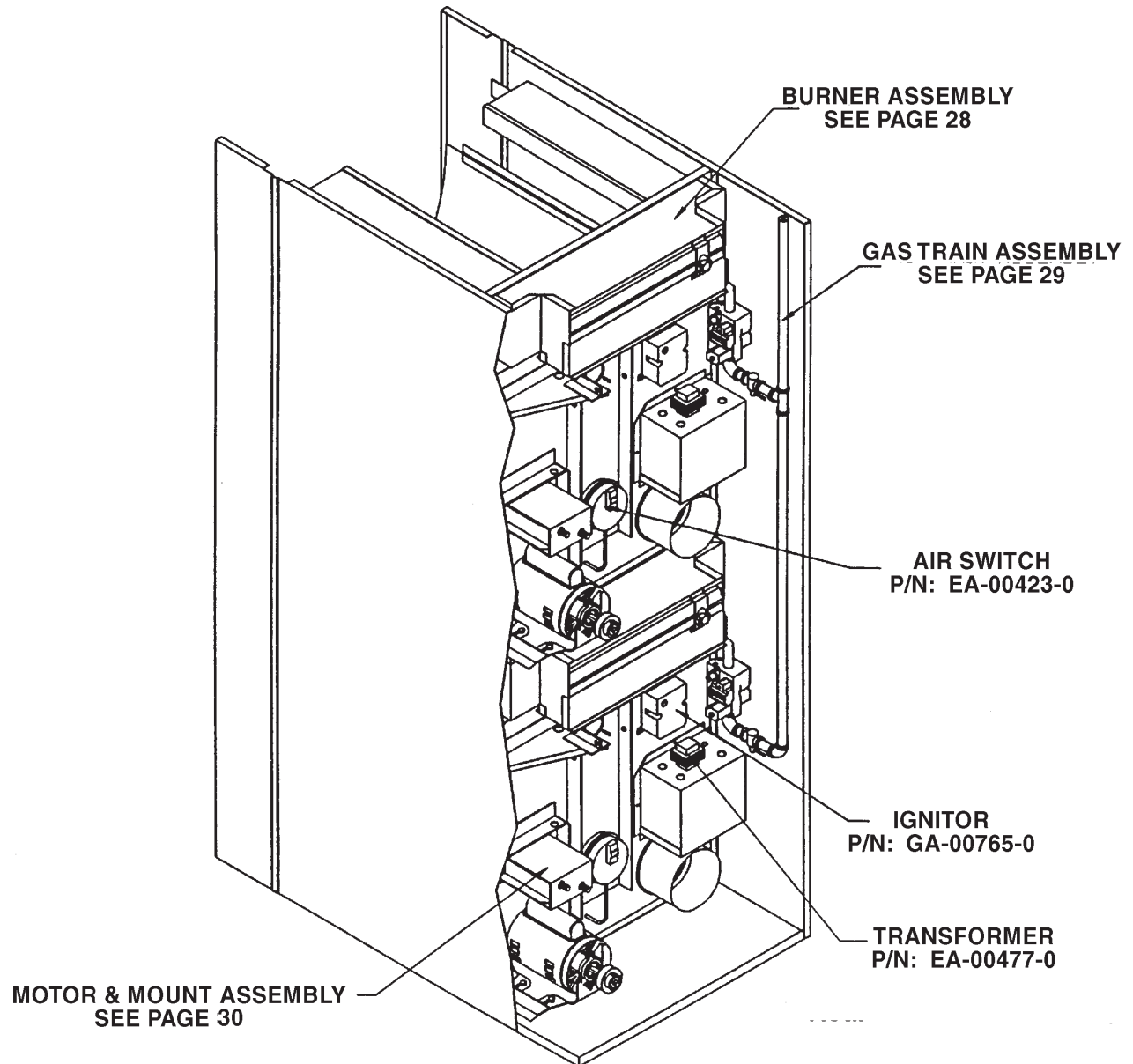

BURNER ASSEMBLY

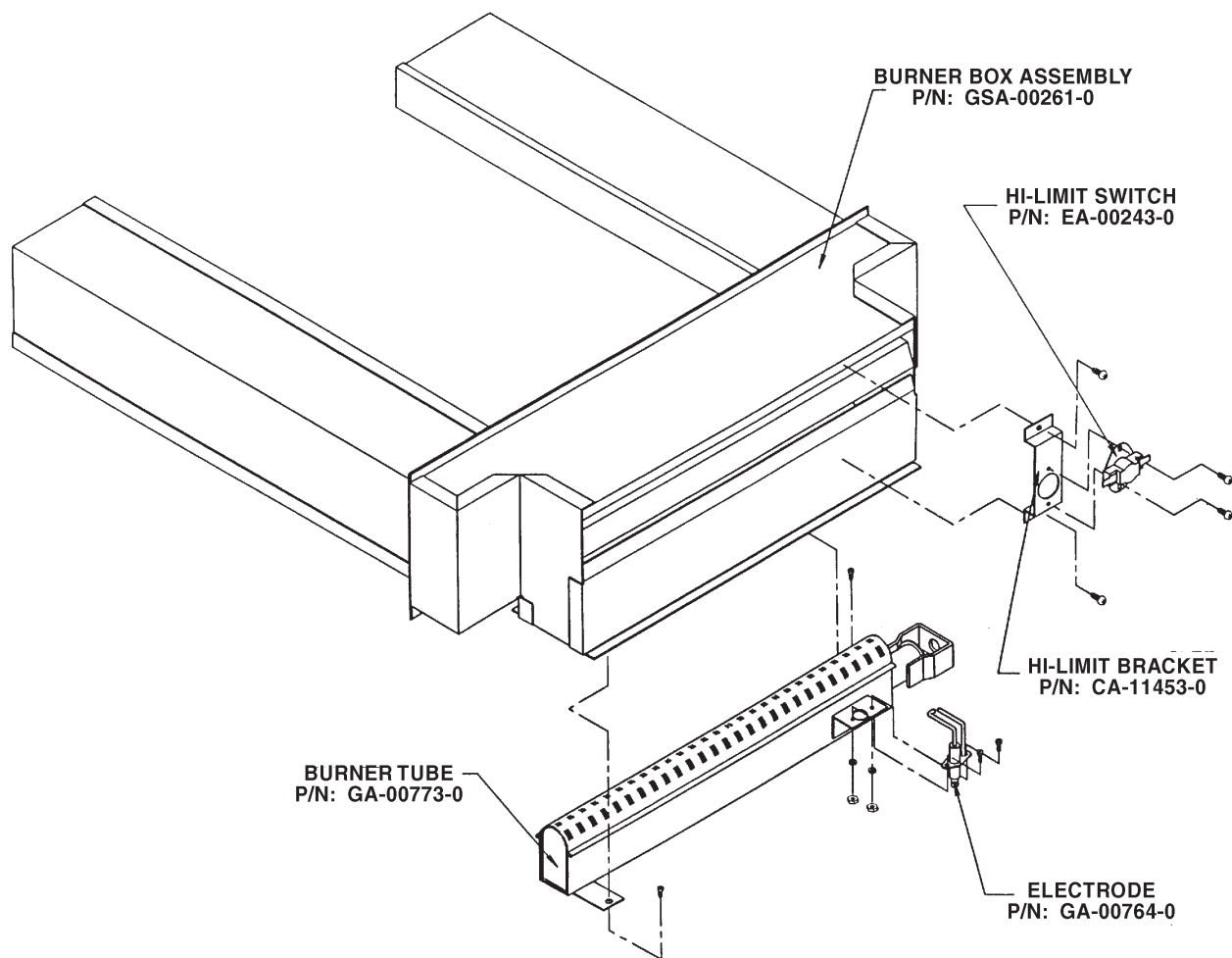

GAS TRAIN ASSEMBLY

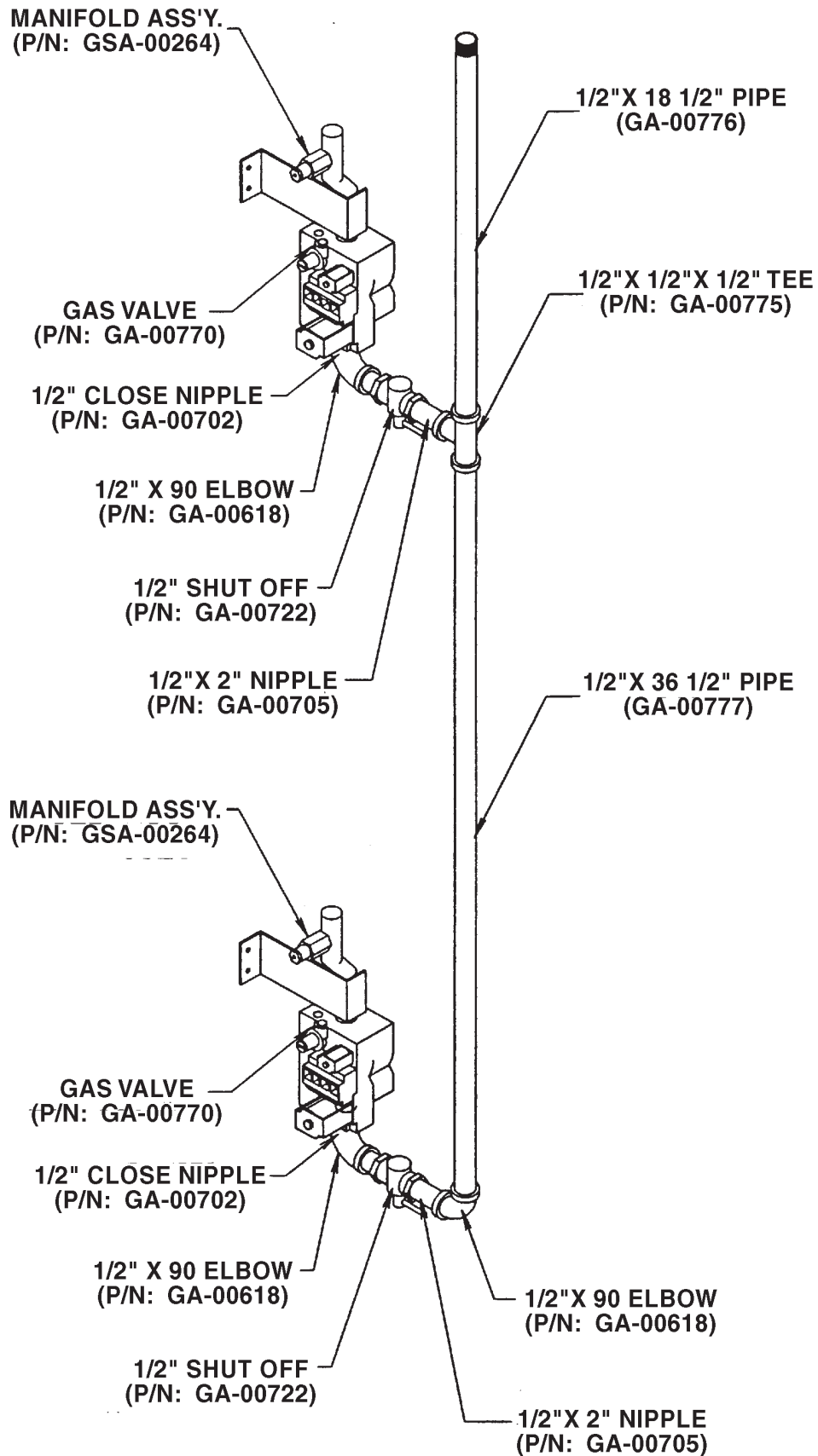

MOTOR & MOTOR MOUNT ASSEMBLY

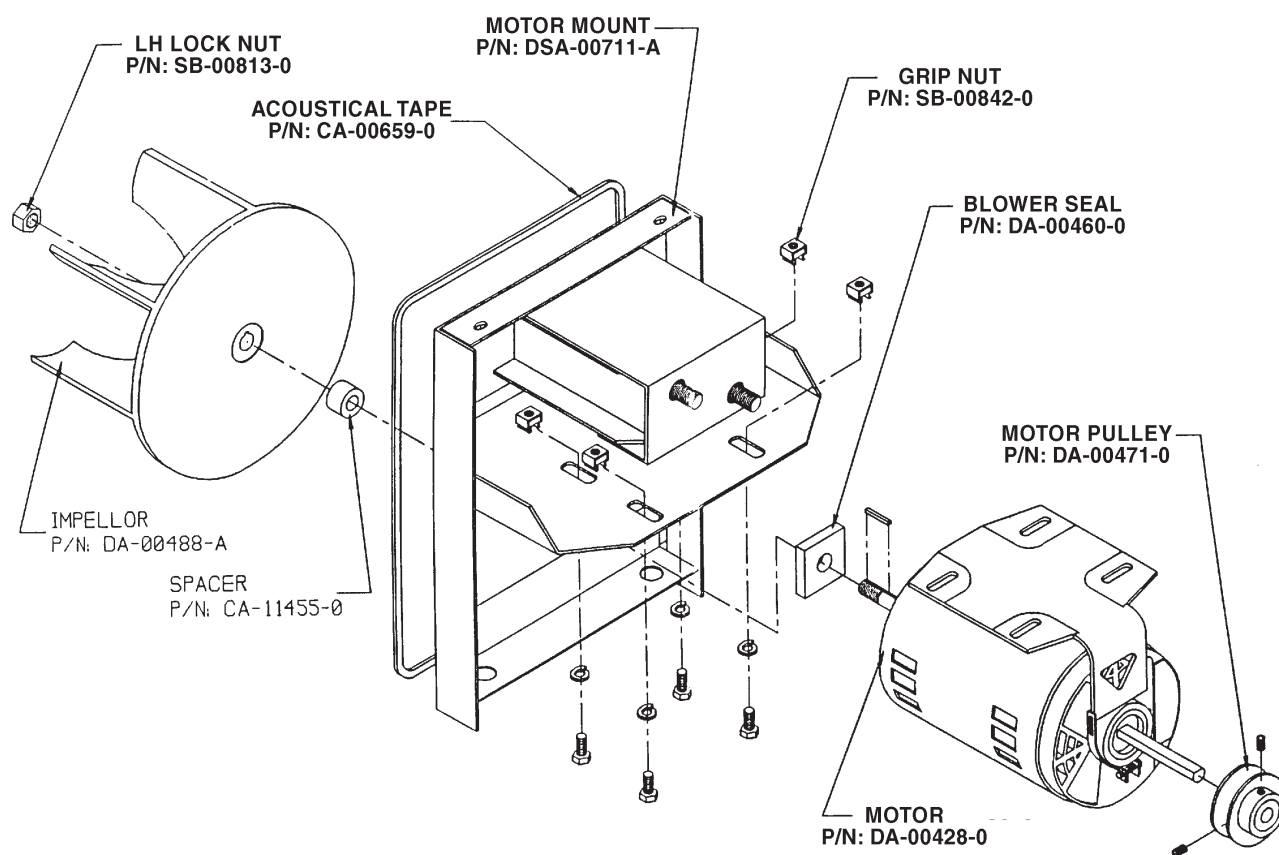

TUMBLER ASSEMBLY

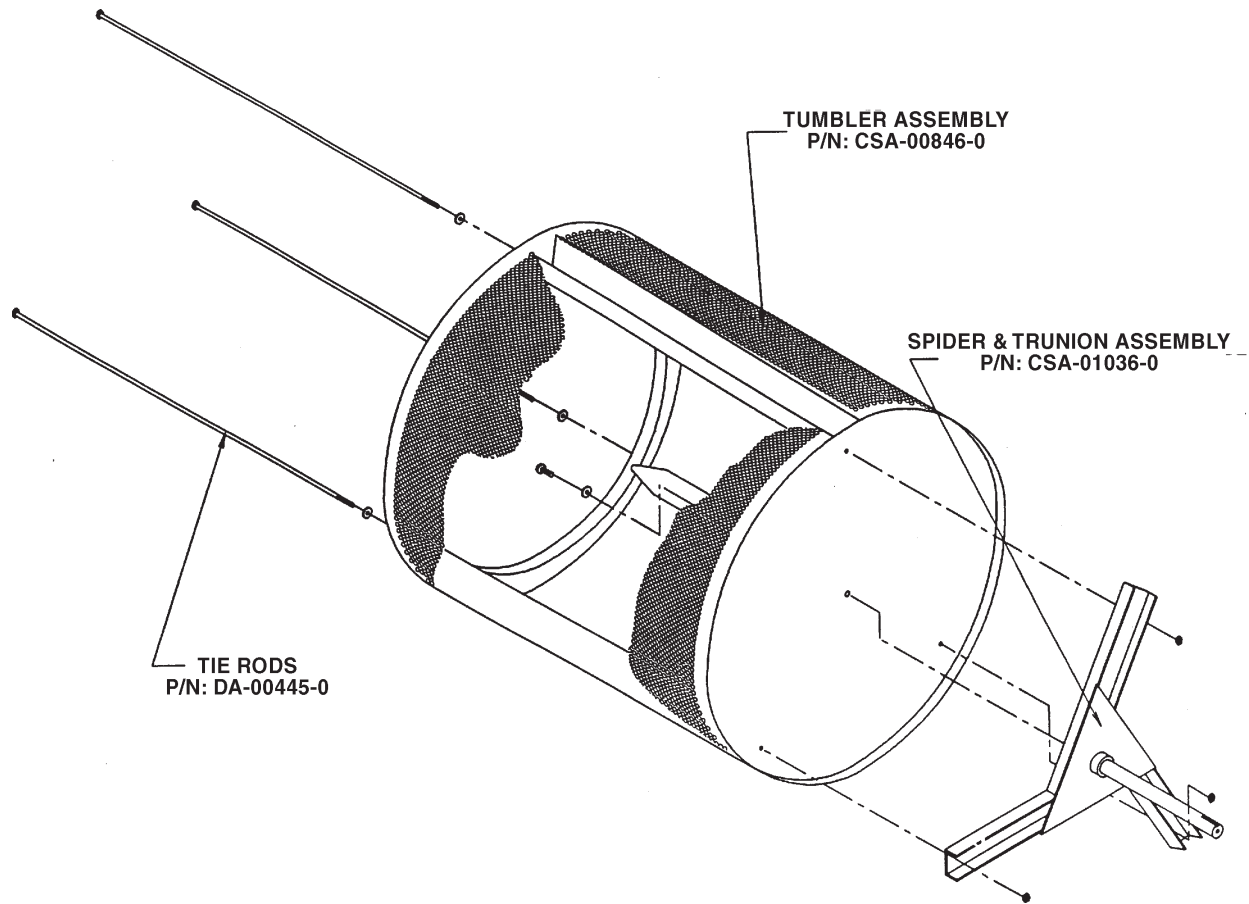

LINT COOP

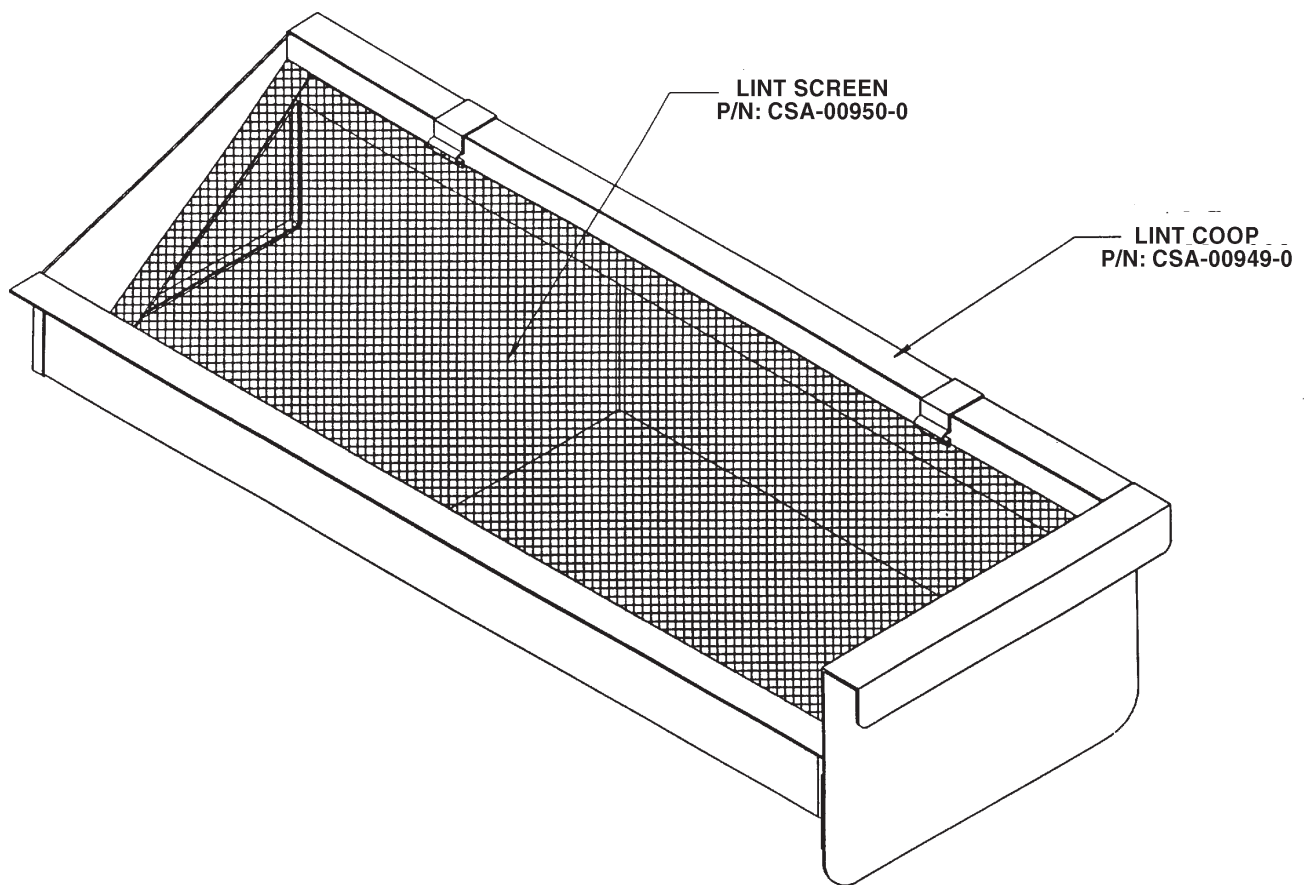

UNDER BASKET THERMOSTAT ASSEMBLY

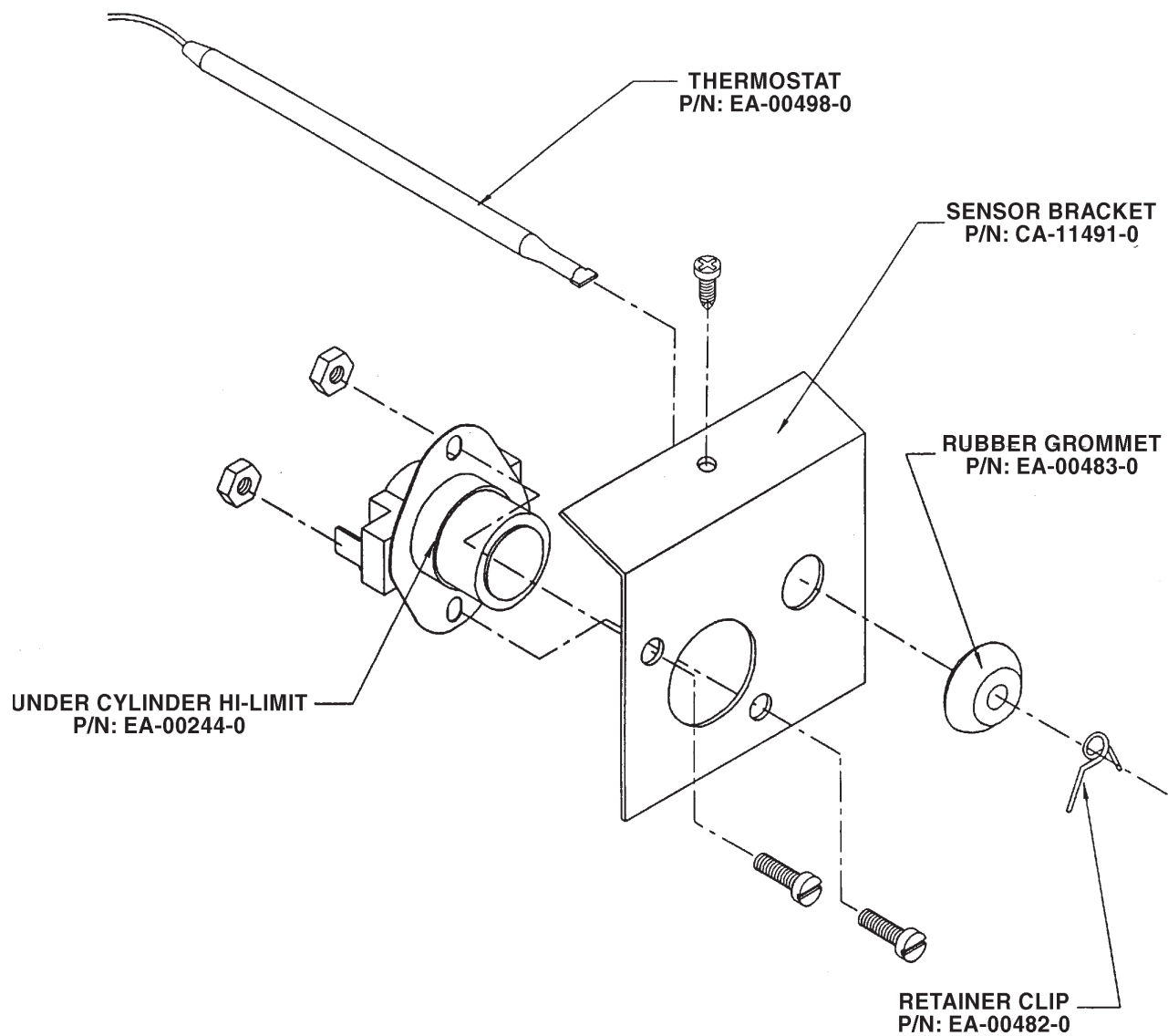

WARRANTY REPAIR

WARRANTY REPAIR

Cissell Manufacturing Co. will repair or replace all parts (except for belts and gaskets) found defective within a period of two years. Your warranty is included in this section - refer to *Repairs* for information. Please read it carefully. Warranty for belts and gaskets found defective will be covered within a period of 90 days.

Warranty is void if dryer is not installed and operated according to instructions in this manual and per applicable local codes and local, state and federal standards.

Assistance

- If you have a problem, first contact your installation contractor or your authorized distributor.
- If the problem cannot be resolved, contact Cissell Manufacturing Co.
- Before calling your distributor or Cissell Manufacturing Co. for assistance, please complete the following:

Model Number _____ **Serial Number** _____

Date purchased _____

Gas specification _____

Distributor Name _____

Address _____

City _____ **State** _____ **Zip** _____

Tel. No. _____

Note

The model number and serial number can be found on the data label located on back left side panel.

REPLACEMENT PARTS

Order replacement parts from your authorized distributor.